







File name: \\EU.AECOM\NET.COM\EMIA\UK\IEDBL2\JOBS\PR-387154_WHITES_CROSS_NEWTOWNPARK_AVE\900_CAD_GIS\910_CADD\02 - SHEETS\387154_SHT_001_A.DWG
 Last saved by: MEEHANT
 Last Plotted: 2019-08-22
 Project Management Initials: Designer: TM Checked: EOM Approved: JS
 ISO A1 594mm x 841mm

KEY:

	EXISTING ROAD CARRIAGEWAY
	PROPOSED ON ROAD CYCLE LANE
	PROPOSED OFF ROAD CYCLE TRACK
	EXISTING ISLAND / FOOTWAY
	EXISTING KERBLINE
	PROPOSED KERBLINE

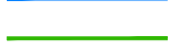
ORDNANCE SURVEY IRELAND LICENCE NO AR0064219
 ©ORDNANCE SURVEY IRELAND / GOVERNMENT OF IRELAND

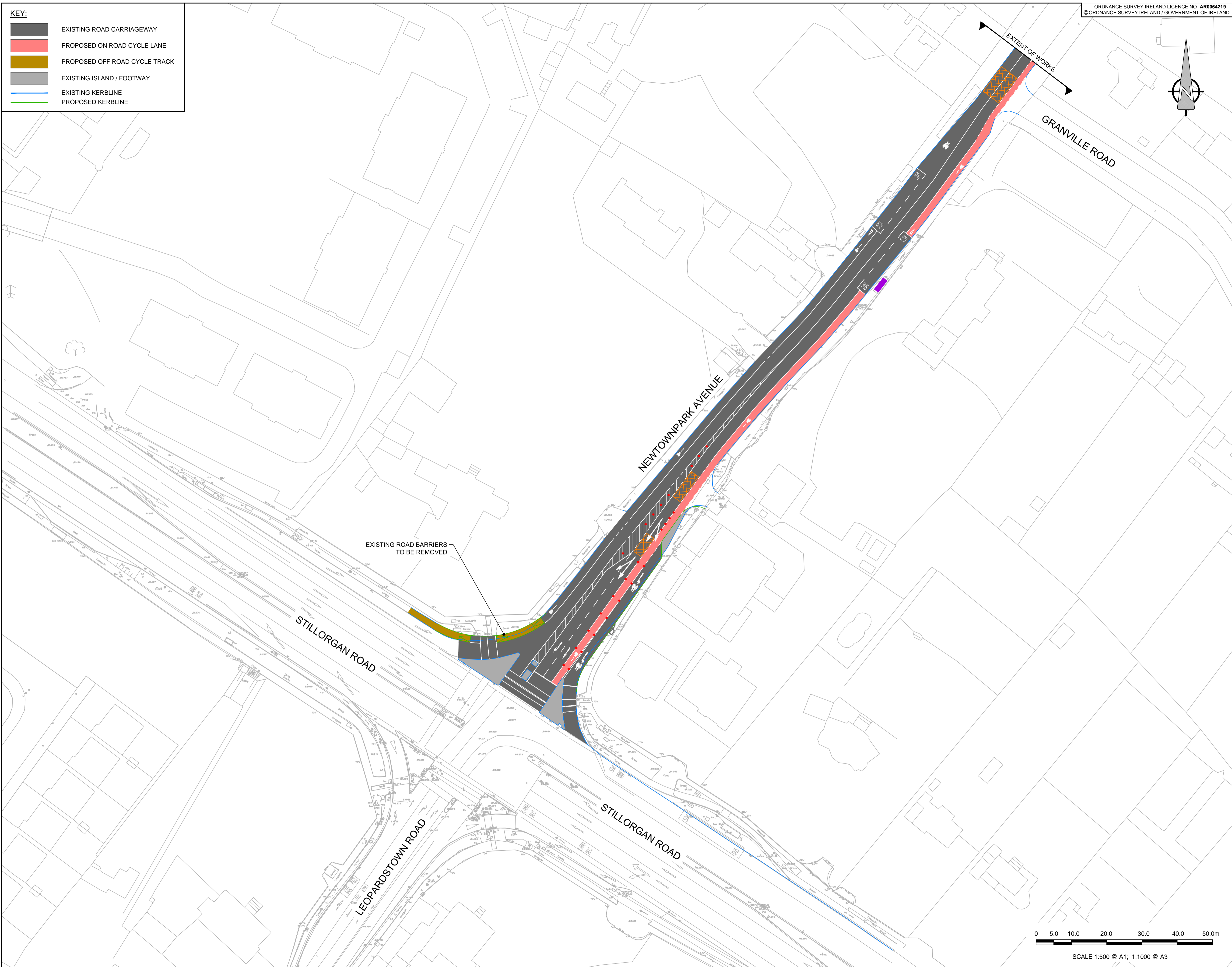
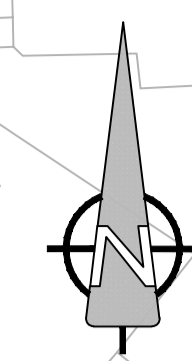

PROJECT
 WHITES CROSS
 N11



CONSULTANT
 AECOM - Roughton & O'Donovan
 Ground Floor, Grand Canal House,
 Upper Grand Canal Street, Dublin 4, Ireland
 Tel:+353(0)1 2383100 Fax:+353(0)1 2383199
 www.aecom.com

- NOTES:**
1. THIS DRAWING IS TO BE READ IN CONJUNCTION WITH ALL OTHER RELEVANT ARCHITECTURAL AND ENGINEERING DRAWINGS. ANY DISCREPANCIES, ERRORS OR OMISSIONS TO BE BROUGHT TO THE ATTENTION OF THE DESIGNER.
 2. ALL DIMENSIONS TO BE CHECKED BY THE CONTRACTOR ON SITE PRIOR TO COMMENCEMENT OF WORKS.
 3. AECOM LIMITED TO BE INFORMED BY THE CONTRACTOR OF ANY DISCREPANCIES PRIOR TO THE COMMENCEMENT OF WORKS ON SITE.
 4. DIMENSIONS OF ALL BOUNDARIES AND ADJOINING ROADS TO BE CHECKED ON SITE PRIOR TO COMMENCEMENT OF WORKS.
 5. DO NOT SCALE, ALL MEASUREMENTS AND COORDINATES TO BE CHECKED ON SITE.

ISSUE/REVISION

AECOM DRAFT		
B	AUGUST 2019	ISSUED FOR INFORMATION
A	JULY 2019	ISSUED FOR INFORMATION
I/R	DATE	DESCRIPTION

PROJECT NUMBER
 387154

SHEET TITLE
 GENERAL ARRANGEMENT

SHEET NUMBER
 SHT_001

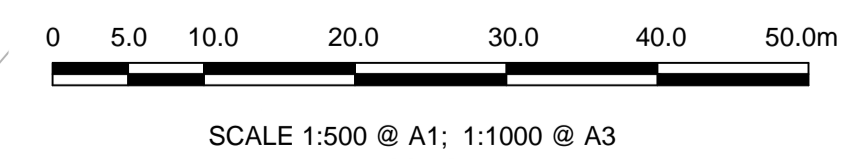

A GENERAL ARRANGEMENT
 001 Scale: 1:500

This drawing has been prepared for the use of AECOM's client. It may not be used, modified, reproduced or relied upon by third parties, except as agreed by AECOM or as required by law. AECOM accepts no responsibility, and denies any liability, whatsoever, to any party that uses or relies on this drawing without AECOM's express written consent. All measurements must be obtained from the stated dimensions.